

6. Options

Tracking & Alert:

Tracking & Alert requires GPS antenna, and setup of the tracking and/or alerting messages. Please refer to the SDMS Application (SatDOCK Management System) to enable and configure Tracking & Alert.

External Alert Button:

Connect Normally-CLOSED button, to the **Brown** and **Green** wires (it can be extended for longer runs). The loop needs to be OPEN (eg. pressing button) for 2 seconds to activate Alert state.



Privacy Handset:

1. The Privacy Handset Kit is ordered separately.
2. Mount the handset cup to the mounting plate.
3. Mount the spacer plate and the mounting bracket, by using the longer screws provided with the kit. (Re-installed the RAM arm-bracket behind these plates).
4. Connect the Privacy Handset 3.5mm plug into the rear cable jack.
5. Privacy Handset mode is active whenever the handset is removed from the cup.



Intelligent Handset:

1. Mount the handset cup in a suitable position
2. Connect the Intelligent handset RJ45 connector into the rear cable jack.
3. Intelligent handset mode is active whenever the handset is removed from the cup



Earpiece-Jack Mode:

Use a 2.5mm earpiece plugged into the right side of the 9555 handset.

1. During a RJ11 or Bluetooth call, to enable Earpiece-Jack Mode, press and hold the Mute button for 1.5 seconds. The LED flashes **ORANGE**.
2. To exit Earpiece-Jack Mode and revert to RJ11 or Bluetooth, press the Mute button once.

7. Add Bluetooth Device (optional)





AUDIO: To configure (pair) to a Bluetooth® headset device:

1. Discovery Mode: **Press and hold for 5 secs** the Bluetooth® button on the cradle. The LED flashes **BLUE** and **ORANGE**.
2. Hold the Headset device button(s) to enter pairing mode.
3. Once paired, the Bluetooth® LED is **BLUE** (half intensity).
4. Bluetooth® can be turned ON with a **single press**, and OFF by **press for 2 secs** the Bluetooth® button on the cradle.

8. Using SatDOCK 9555

- After applying power to AC power adaptor or turning key/Acc on, the SatDOCK will beep upon power up
- Wait for phone to power up and register

PANEL BUTTONS AND INDICATORS:

BUTTON	BUTTON MODE	LED/SOUND
	Out of Call (single press): Select Ringer Tones	LED off. Preview and select ringer sounds.
	Out of Call (1.5 second press) Auto-Answer Mode: Subsequent 1.5 second press exits auto-answer	LED is GREEN , single beep.
	During In-Call Hands-free, Privacy/Intelligent handset or Bluetooth®: Mute (single press)	LED is RED when MUTE.
	During In-Call Bluetooth®: Earpiece-jack (1.5 seconds press) Subsequent single press, exits Earpiece-jack	LED flashes ORANGE .
	Bluetooth® On (single press)	LED is BLUE (half intensity) when Bluetooth® ON and is connected LED is fast-flashing in BLUE when searching paired device.
	Bluetooth® OFF (1.5 seconds press)	LED is slow-flashing BLUE when a connected Bluetooth® device is in use. Single beep sounds when Bluetooth® turning OFF.
	Discovery Mode (5 seconds press)	LED flashes ORANGE and BLUE . Ringer sounds double (2) beeps.
	Clear Bluetooth® Devices (10 seconds press)	Ringer sounds triple (3) beeps.
	Send Tracking Message (single press)	LED and beep operates according to the settings in PDMS.
	Clear Alert Mode (7 seconds press)	LED turns GREEN re-armed & GPS fix ready. Single Beep sounds. If LED is flashing in GREEN – No GPS fix, or no Iridium signal LED is OFF when Track & Alert is disabled.
 + 	Activate Alert Mode (2 seconds press, BOTH buttons together)	Track LED turns RED when alert is triggered and single beep sounds. Track LED is flashing in RED when the alert message is sent. Track LED is flashing in ORANGE when the alert message is acknowledged by a remote host.



QUICK START GUIDE

iridium SatDOCK 9555
with built in GPS



Suitable for the Iridium 9555
Portable Satellite Telephone

Beam Communications Pty Ltd



www.beamcommunications.com
info@beamcommunications.com
TEL: +61 3 8588 4500 FAX: +61 3 9560 9055

USR03G05501

1. SatDOCK Installation Set Up

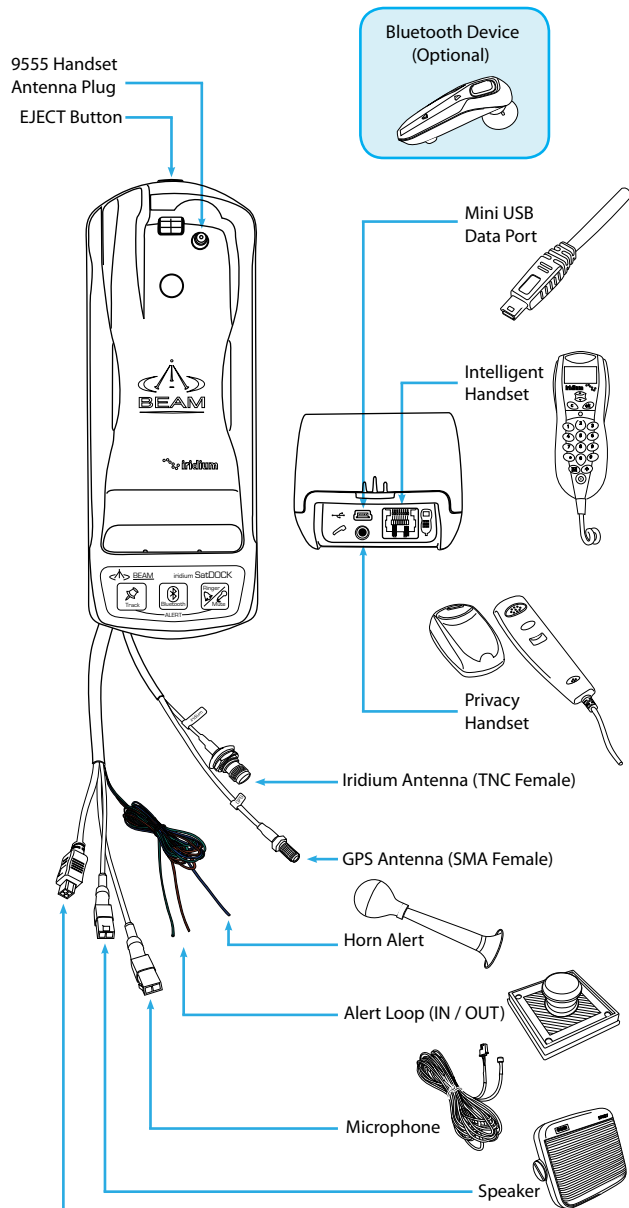

INSTALL POWER:

BLACK = 0V Ground to negative Battery.

RED + VIN wire to the vehicle + Battery (3A fuse).

YELLOW Acc (On/Off sense) to vehicle acc/key, or on/off switch (1A fuse).

If not required, this **YELLOW** wire **MUST** be connected to +VIN (**RED WIRE**)

2. Installing SatDOCK Cradle



Considerations:

- Affix the base plate in a location that allows easy access & does not obstruct driver
- Allow sufficient room to easily run cables from the SatDOCK
- ONLY use the M4 screws (supplied) to affix the base to the SatDOCK to avoid any damage
- For wall mounting use the RAM Bracket with both bases parallel to each other
- Tighten wing nut on the bracket to securely hold the SatDOCK
- Avoid making any sharp bends in the antenna cable when determining the cable route
- The fixed cables from the SatDOCK should never be extended, Antenna cables must be approved

3. Installation

- DO NOT route cables near areas of intense heat
- DO NOT pull or strain the cables from the SatDOCK

Connecting to Power:

- Connect AC power Adaptor, or DC Cable Lead (9-32V DC input > 25 watts)

Connecting to the Antennas:

- Only certified cables within the Iridium specification should be used
- Ensure antenna cables are routed avoiding any sharp bends in the cable
- The antenna should always be installed with clear line of site to the sky

SatDOCK USB Data Port:

- The SatDOCK has an integrated USB Data Port on the rear. Drivers for this USB port can be download from <http://www.beamcommunications.com/support/satdock9555>



WARNING: Your Iridium 9555 Handset requires firmware HT10001 or greater. To check your firmware version on your Iridium 9555 handset press "Menu" then navigate to "Setup" then "Phone Information". For more information and 9555 Handset firmware downloads visit: <http://www.beamcommunications.com/support/satdock9555>



NOTE: For Data operation the USB port on the Iridium 9555 handset must not be used whilst docked in the cradle. Please use the USB port located on the bottom of the 9555 cradle.

4. MIC / Audio Connections

Connecting Microphone:

- The microphone should be connected to the HFI and then recessed up the door pillar or similar to a head height location close to the driver
- Care should be taken to avoid wind or high noise environments
- Avoid crimping or damaging the microphone cable during installation

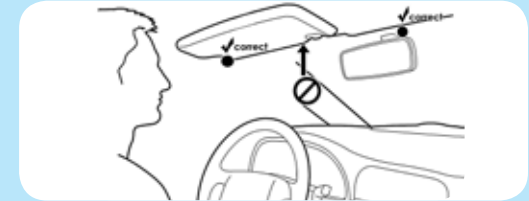

Installing Speaker:

- Mount the speaker underneath the seat or other location that avoids the speaker facing the microphone
- If feedback occurs upon testing try redirecting the speaker or locate in another location.

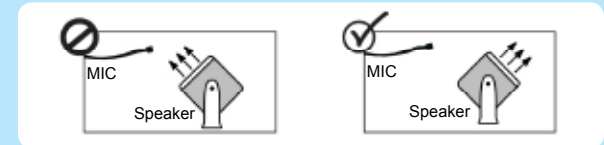

5. Inserting & Ejecting 9555 Handset

Inserting:

1. Remove rubber grommet on back of 9555 antenna connection
2. Ensure 9555 handset is turned off
3. Ensure there is no foreign object in the cradle
4. Place the 9555 in the cradle with the base in first
5. The base connector should line up with the base of the 9555
6. Press EJECT button and phone at the same time to securely lock the phone in the docking station.



1. Place 9555 on the base of the cradle & push into the cradle

2. Push EJECT and phone at the same time

Ejecting:

To remove the 9555 handset from the cradle **FIRMLY** press the "Eject" button located on the top of the cradle (see diagram).



1. Firmly press 'Eject' Button

2. Release the phone